

**Created in 1884**, MNAA-Museu Nacional de Arte Antiga, the main museum in Portugal, houses the most relevant public collection, from the 12th to the 19th century: painting, sculpture, silver, gold and jewellery, decorative arts – Portuguese, European, African and Oriental –, including the largest number of works classified as “national treasures”.

Among them, *The Panels of Saint Vincent*, by Nuno Gonçalves, and the *Belém Monstrance*, commissioned by king Manuel I and made with the gold brought by Vasco da Gama on his second return from India, symbols of 15th and 16th centuries Portuguese art, and notable paintings like *The Temptations of Saint Anthony*, by Jheronimus Bosch, *Saint Augustine*, by Piero della Francesca, *Saint Jerome*, by Albrecht Dürer, *Virgin and Child*, by Hans Memling, or *A Miracle of Saint Eusebius of Cremona*, by Raphael.

The museum has a magnificent garden, with restaurant, over the River Tagus.

#### OPENING TIMES

Tuesday to Sunday:  
10am – 6pm

Closed: January 1, Easter Sunday,  
May 1, June 13 and December 25

#### EDUCATION DEPARTMENT

Booking for guided visits  
se@mnaa.dgpc.pt  
T +351 213 912 800

#### CABINET OF DRAWINGS AND PRINTS

Booking  
T +351 213 912 839/00

#### LIBRARY

Specialized in History of Art  
Tuesday to Friday:  
10am – 1pm / 2:30pm – 5pm  
Free access (Wi-Fi)

#### RESTAURANT

Free access (Wi-Fi)

#### GARDEN

Free access (Wi-Fi)

#### GETTING HERE

Rua das Janelas Verdes  
Bus 713, 714, 727  
Av. 24 de Julho  
Bus 728, 732, 760  
Trams 15E, 18E  
Largo de Santos  
Tram 25E  
GPS  
38.704516  
-9.162278



Restaurant



Toilets



Shop



Tickets / Cloakroom



Lift

© Direção-Geral do Património Cultural / Arquivo de Documentação Fotográfica (DGPC/ADF)

www.fba.pt

EN

# MNAA

MUSEU NACIONAL DE ARTE ANTIGA

Museu Nacional de Arte Antiga  
Rua das Janelas Verdes  
1249-017 Lisboa, Portugal  
T +351 213 912 800  
geral@mnaa.dgpc.pt  
www.museudearteantiga.pt  
www.facebook.com/museunacionaldearteantiga

REPÚBLICA  
PORTUGUESA  
CULTURA

PATRIMONIO  
CULTURAL  
Direção-Geral do Património Cultural

MNAA  
MUSEU NACIONAL DE ARTE ANTIGA

# 0 LEVEL

- A. TEMPORARY EXHIBITIONS GALLERY
  - B. TEMPORARY EXHIBITIONS GALLERY
  - C. LIBRARY
  - D. AUDITORIUM
  - E. CABINET OF DRAWINGS AND PRINTS
  - F. MEZANINO ROOM
- Temporary exhibitions

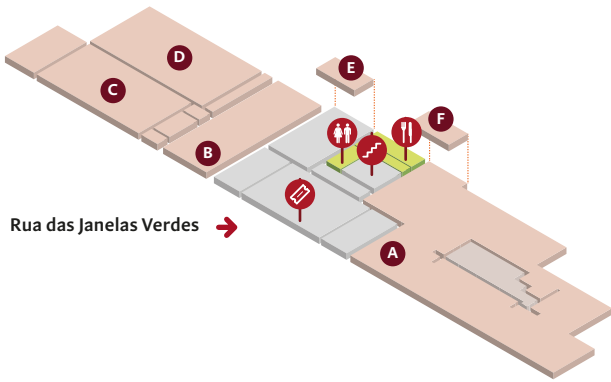

# 1 LEVEL

- G. TECTO PINTADO ROOM
  - Temporary exhibitions
  - H. SAINT ALBERT CHAPEL
  - I. CRIBS ROOMS
  - J. TEXTILES
- PORTUGUESE FURNITURE  
Rooms 36 – 44
- EUROPEAN DECORATIVE ARTS  
Rooms 48 – 49, 55 (closed), 66 – 70
- EUROPEAN PAINTING  
Temporarily closed

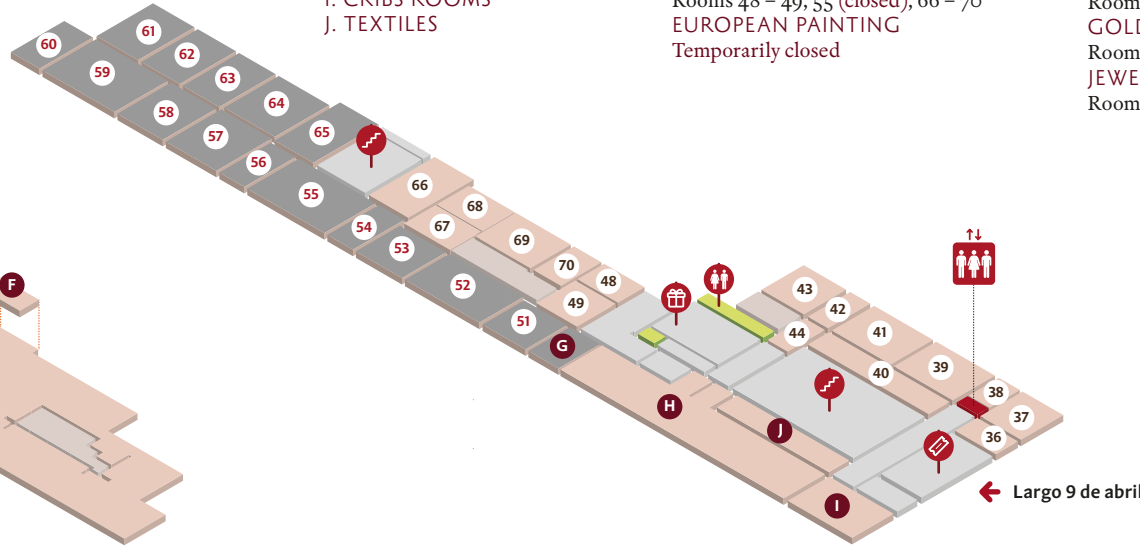

# 2 LEVEL

- ART FROM THE PORTUGUESE DISCOVERIES  
Rooms 14 – 18
- CERAMICS  
Rooms 19 – 25
- GOLD AND SILVERWARE  
Rooms 26 – 29
- JEWELLERY  
Room 30

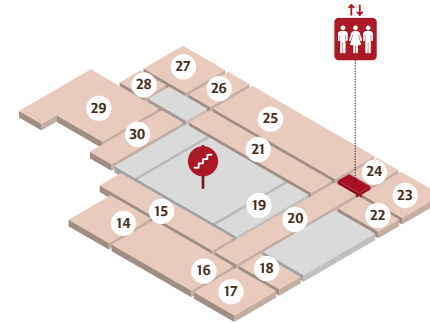

# 3 LEVEL

- PORTUGUESE PAINTING AND  
SCULPTURE  
Rooms 1 – 13

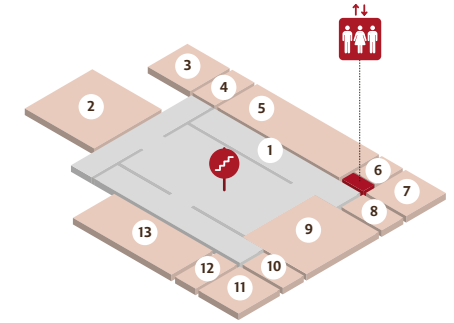

**Giovanni Battista Tiepolo**  
*The Flight into Egypt*,  
1767-70  
[level 1, room 52]



**Pieter de Hooch**  
*Merry Company*,  
c. 1663-65  
[level 1, room 54]



**Andrea della Robbia**  
*Saint Leonard*, 1501-15  
[level 1, room 55]



**Francisco de Zurbarán**  
*Saint Peter*, 1633  
[level 1, room 58]



**Lucas Cranach, the Elder**  
*Salome with the Head of Saint John the Baptist*,  
c. 1510  
[level 1, room 61]



**Jheronimus Bosch**  
*The Temptations of Saint Anthony Abbot*, c. 1500  
[level 1, room 61]



**Kano Naizen**  
*Namban Screens*  
Japan, c. 1600  
[level 2, room 14]



**Saltcellar**  
Benin, c. 1525  
[level 2, room 18]



**Dish with Matias de Albuquerque coat of arms**  
China, 16th century  
[level 2, room 21]



**Domingos António de Sequeira**  
*The Adoration of the Magi*  
1828  
[level 3, room 1]



**Nuno Gonçalves**  
*Panels of Saint Vincent*,  
c. 1460-70  
[level 3, room 2]



**Unknown Portuguese Master**  
*Hell*, c. 1510-20  
[level 3, room 5]



**Albrecht Dürer**  
*Saint Jerome*, 1521  
[level 1, room 61]



**Piero della Francesca**  
*Saint Augustine*, 1460-70  
[level 1, room 63]



**Rafael Sanzio**  
*A Miracle of Saint Eusebius of Cremona*, c. 1502-03  
[level 1, room 63]



*The Baptism of Christ*  
Brussels, 16th century  
[level 1, room 64]



**Pierre Bernard**  
Commode, France,  
18th century  
[level 1, room 68]



**Ambroise-Nicolas Cousinet**  
Statuette, Paris, 1757-58  
[level 1, room 69]



*Processional Cross*  
Portugal, 1214  
[level 2, room 29]



**Gil Vicente**  
*Belém Monstrance*, 1506  
[level 2, room 29]



**Mestre João**  
*Reliquary of Queen D. Leonor*, c. 1510  
[level 2, room 29]



*Two Headed Fountain*  
Portugal, 1501-15  
[level 3, room 7]



**Gregório Lopes**  
*The Martyrdom of Saint Sebastian*  
Portugal, 1536-39  
[level 3, room 9]



**Cristóvão de Morais**  
*Portrait of King D. Sebastião*, 1571  
[level 3, room 10]